



**FLANGE USA™**

# CTS Venturi Flow Meter

*The CTS stainless steel Venturi Flow Meter provides accurate flow measurement for hydronic heating & cooling systems.*



The CTS Venturi Flow Meter is a flanged variable orifice to ensure evenly distributed flow in zones, branches, risers & terminal units in commercial installations. It provides accurate flow measuring in one complete unit.

- ▶ **Floating flange connection with EPDM insulator:**
  - Ease of installation – flexible pipe work alignment
  - Insulation can be easily applied to pipe body
- ▶ **Stainless Steel one piece housing with integral sampling points:**
  - No welds or joins
  - Corrosion resistant
  - Light weight
- ▶ **Synthetic polymer Venturi insert:**
  - High degree of measurement accuracy (+/- 2.5%)
  - Serviceable on site
- ▶ **Range of sizes available**
  - Sizes from 2½" - 8" available
  - ANSI 150LB

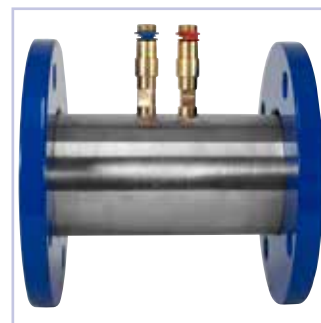

# CTS Venturi Flow Meter Specification

Maximum Pressure	216 Bar 232 PSI (pressure rating as per flange)
Temperature Range	-4°F to 203°F
End Connections	ANSI 150LB
Size Range	2½" to 8"
Flow Range	28 thru 1,585 GPM
Flow Accuracy	+/- 2.5%

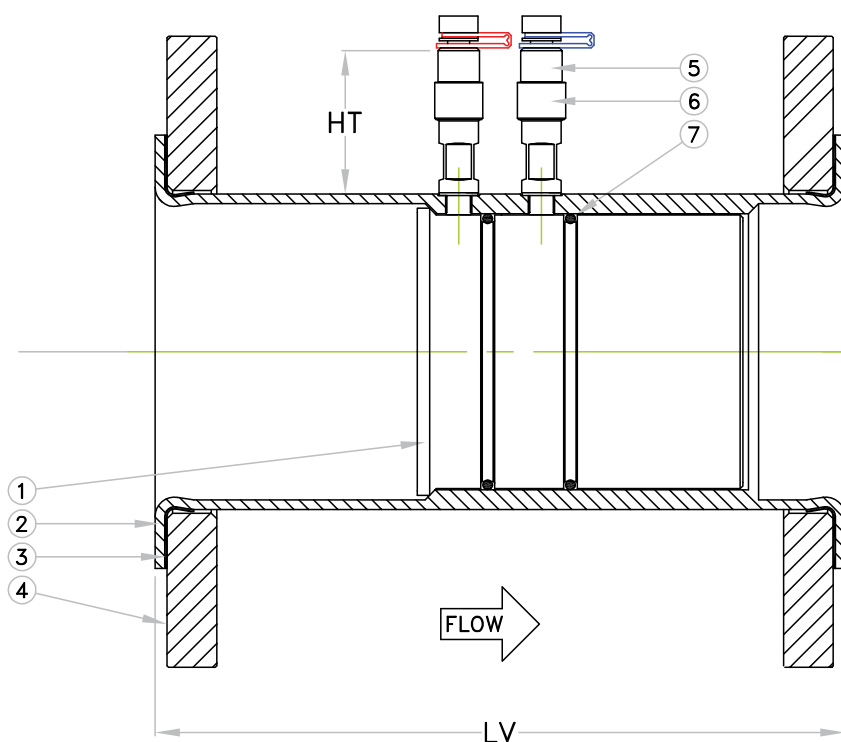

### Bill of Materials:

1	Venturi	Synthetic polymer
2	Venturi Housing	S/Steel
3	Insulator Gasket	EPDM
4	Floating Flange	Coated Steel or S/Steel
5	Test Point	DZR Brass - EPDM
6	Spacer (TP)	DZR Brass or S/Steel
7	O-Ring	EPDM (other if required)

### Flow Rate Recommendation Guide:

Size (Inches)	Flow Ranges (GPM)		Cv Signal (Across Test Points)
	Minimum	Maximum	
2½	28	110	43.5
3	55	237	85.0
4	98	412	150
5	142	634	220
6	266	903	400
8	443	1,585	680

\* Flow charts available from [ctsflange.com](http://ctsflange.com)

### Dimensions - Inches:

Size	2.5"	3"	4"	5"	6"	8"
LV	6.9	7.9	9.8	10.8	11.8	13.8
* HT	2.0	2.0	2.0	2.0	2.0	2.0

\* Longer test point extensions available if required.