

Spec sheet measurements accurate at time of printing.

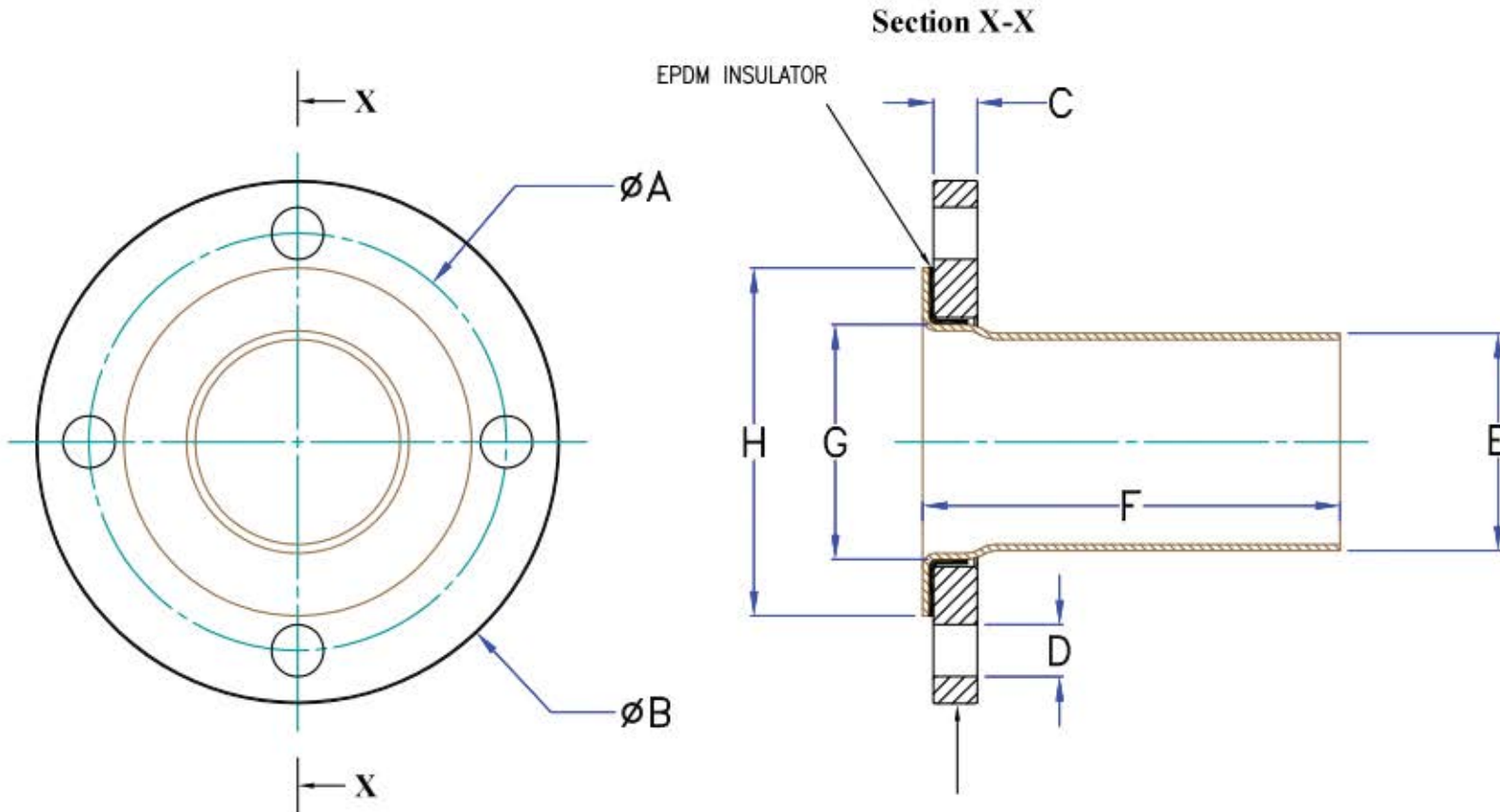

EDGE OF FLANGE MARKED WITH  
 CTS (Size) INCH 150LB - ANSI B16.5 (Heat Number\*)  
 EG: CTS 3 INCH 150LB - ANSI B16.5 13J3857  
 (\*If Specified)

	2 INCH	2.5 INCH	3 INCH	4 INCH
Code	SF002	SF025	SF003	SF004
A. Bolt Circle Diam	4.75	5.50	6.00	7.50
B. Flange Diameter	6.00	7.00	7.50	9.00
C. Flange Thickness	0.63	0.63	0.63	0.71
No. Bolt Holes	4	4	4	8
D. Bolt Hole Diam	0.75	0.75	0.75	0.75
E. Cu Tube End OD	2.125	2.625	3.125	4.125
F. Cu Piece Length	6.00	6.00	6.00	6.00
G. Cu Pce Flare OD	2.31	2.85	3.38	4.43
H. Cu Flange OD	3.75	4.33	5.01	6.48



ANSI B16.5 150LB POWDER COATED  
 CTS FLANGE & COPPER SPIGOT  
 FOR USE WITH PRESS FIT FITTINGS



Dimension Unit.  
 Inches (Decimal)

DRN BY: \_EAS\_  
 DATE: 08/12/2012  
 CHK BY: \_EAS\_  
 DATE: 08/12/2012  
 APR BY: \_EAS\_  
 DATE: 08/12/2012

CTS

FLANGE

Rev. A

Drawing No.  
 USA-20170317-104